

CONCEPTUAL SITE LAYOUT

28th Street Stormwater Infiltration Project



EXISTING PARKING STALLS

NON-STANDARD SPACES = 68
 OCEAN DRIVE SPACES = 8
 TOTAL = 76

LEGEND

= PARKING STALLS PROVIDED ON THAT ROW

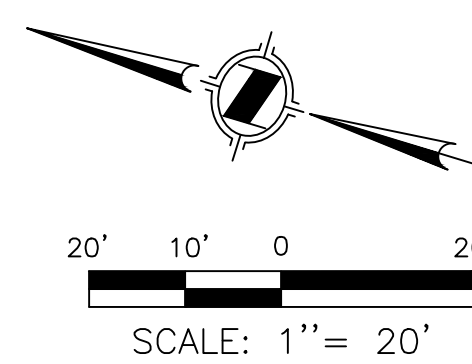
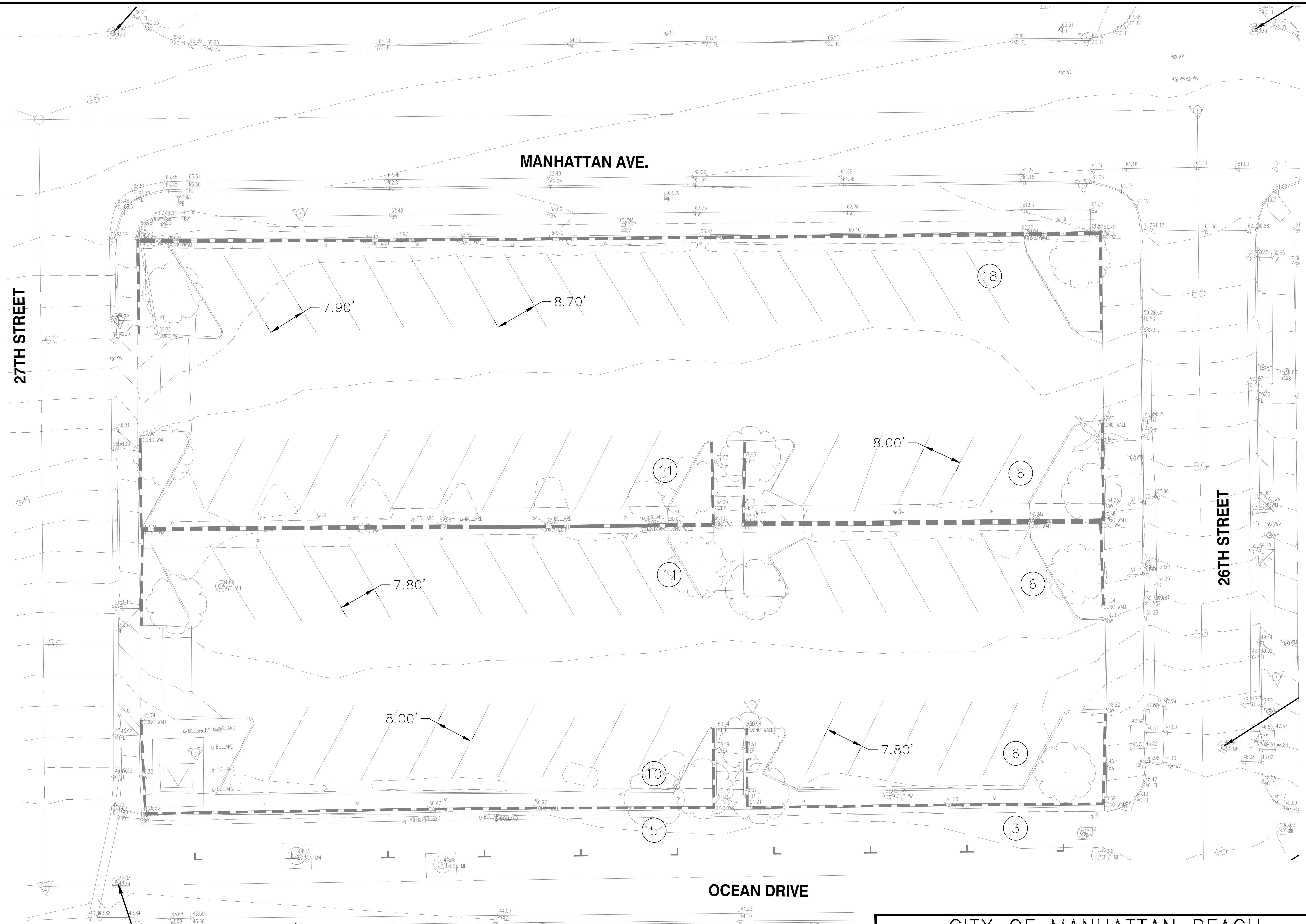

811
 Know what's below.
 Call before you dig.

NO WORK SHALL BE DONE ON THIS SITE UNTIL USA AGENCY IS NOTIFIED OF INTENTION TO GRADE OR EXCAVATE, TWO WORKING DAYS BEFORE YOU DIG.

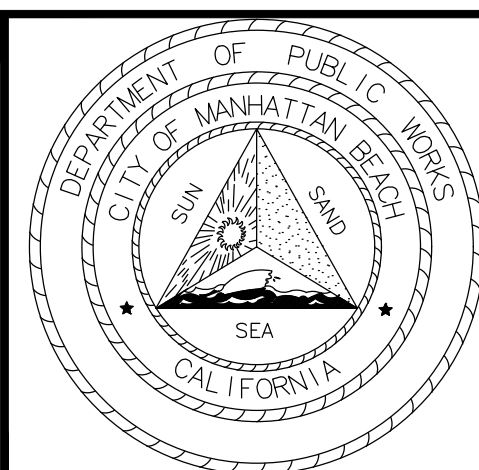

SUPPLEMENTAL NOTES:

1. THE CONTRACTOR SHALL LOCATE, VERIFY AND PROTECT ALL EXISTING UNDERGROUND UTILITIES. DAMAGED UTILITIES SHALL BE REPLACED IN KIND AT THE CONTRACTOR'S EXPENSE.
2. DUE TO INDIVIDUAL LOT IMPROVEMENTS, THE EXISTING WATER, SEWER AND/OR GAS LATERALS MAY NOT BE AT THE LOCATIONS SHOWN OR SHOWN IN THEIR ENTIRETY. THE CONTRACTOR SHALL EXERCISE CAUTION WHEN EXCAVATING.
3. THE CONTRACTOR SHALL DETERMINE THE DEPTH OF GAS, SCE, CABLE, SEWER, STORM DRAIN AND WATER AT ALL INTERSECTIONS AND INTERFERENCES PRIOR TO CONSTRUCTION AND AS NOTED ON PLANS.

DATE SIGNED: _____

PREPARED BY:

 1561 E. ORANGETHORPE AVE.
 SUITE 240
 FULLERTON, CA 92831
 (714) 526-7500
 www.cwecorp.com

REVIEWED BY	DATE

CITY OF MANHATTAN BEACH
 PUBLIC WORKS DEPARTMENT - ENGINEERING DIVISION

**MANHATTAN BEACH 28TH STREET
 STORMWATER INFILTRATION PROJECT
 EXISTING PARKING STALL COUNT**

NO.	BY	DATE

DESIGNED BY	DATE	APPROVED BY	DATE
PROJECT MANAGER KATIE HARREL		CITY ENGINEER KATHERINE DOHERTY	
PROJECT ENGINEER CESAR RAMIREZ			

SCALE	DATE	DRAWING NO.
AS SHOWN	MARCH 2024	C-1

SHEET 19 OF 52

PROPOSED PARKING STALLS

STANDARD AND COMPACT SPACES = 64
 OCEAN DRIVE SPACES = 9
 TOTAL = 73

EXISTING PARKING STALLS

NON-STANDARD SPACE = 76

LEGEND

= PARKING STALLS PROVIDED ON THAT ROW

27TH STREET



26TH STREET

OCEAN DRIVE

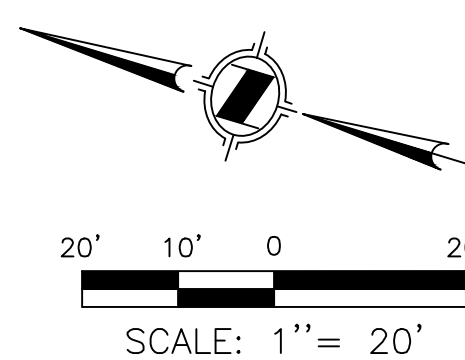

811
 Know what's below.
 Call before you dig.

NO WORK SHALL BE DONE ON THIS SITE UNTIL USA AGENCY IS NOTIFIED OF INTENTION TO GRADE OR EXCAVATE, TWO WORKING DAYS BEFORE YOU DIG.



SUPPLEMENTAL NOTES:

1. THE CONTRACTOR SHALL LOCATE, VERIFY AND PROTECT ALL EXISTING UNDERGROUND UTILITIES. DAMAGED UTILITIES SHALL BE REPLACED IN KIND AT THE CONTRACTOR'S EXPENSE.
2. DUE TO INDIVIDUAL LOT IMPROVEMENTS, THE EXISTING WATER, SEWER AND/OR GAS LATERALS MAY NOT BE AT THE LOCATIONS SHOWN OR SHOWN IN THEIR ENTIRETY. THE CONTRACTOR SHALL EXERCISE CAUTION WHEN EXCAVATING.
3. THE CONTRACTOR SHALL DETERMINE THE DEPTH OF GAS, SCE, CABLE, SEWER, STORM DRAIN AND WATER AT ALL INTERSECTIONS AND INTERFERENCES PRIOR TO CONSTRUCTION AND AS NOTED ON PLANS.

DATE SIGNED: _____

PREPARED BY:

 1561 E. ORANGETHORPE AVE.
 SUITE 240
 FULLERTON, CA 92831
 (714) 526-7500
 www.cwecorp.com

REVIEWED BY	DATE

CITY OF MANHATTAN BEACH
 PUBLIC WORKS DEPARTMENT - ENGINEERING DIVISION

**MANHATTAN BEACH 28TH STREET
 STORMWATER INFILTRATION PROJECT
 PROPOSED PARKING STALL COUNT**

REFERENCES	NO.	BY	DATE

REVISIONS	NO.	DATE

DESIGNED BY CESAR RAMIREZ	DATE	APPROVED BY KATHERINE DOHERTY	DATE
PROJECT MANAGER KATIE HARREL	DATE	CITY ENGINEER KATHERINE DOHERTY	DATE

SCALE AS SHOWN	DATE MARCH 2024	DRAWING NO. C-1
SHEET 19 OF 52		

90% CONSTRUCTION PLAN

Z:\22448\06 Tasks\01 Design\40 Alternatives\22448 - Alternative Site Config Exhibit 2.dwg